

ARENA

T O R Q U A Y

HIRE PACK



info@arenatorquay.com



www.arenatorquay.com

CONTENTS



VENUE
INFORMATION



FLOOR PLAN
& VISUALS



TECH SPEC



LOAD-IN &
OUT



CONTACT
INFORMATION



WHATS
NEARBY?



GETTING HERE



ARTIST & CREW
FACILITIES



RATES



CAPACITY

Standing: 1200 (including staff, artists & crew)

Theatre Seated: 450

Banquet Style: 330

DOOR & CURFEW

Door times are as per your requirements; however, please note our standard door time for concerts is **7.30pm** with a **12.00am** noise curfew for live music and **01:00am** for recorded music.

LICENSE

Our alcohol license is until **01:30am**.

AGE RESTRICTIONS

The venue welcomes all ages to its events but please note that **Under 14s** must be accompanied by an adult over the age of **18** at all times.

Various licensing rules apply for **under 18's** events - please contact us for more information

VENUE INFORMATION

TICKETING

Daytime Walk In Box Office: Venue Box Office is open for personal callers: **Monday – Friday 9.00am – 5.00pm.**

Tickets may also be available on the door for each event if they are not already sold out.

Arena Torquay, 39-41 Torwood Street, Torquay, TQ1 1DZ

On line: www.arenatorquay.com

The venue requires a minimum of a **50% allocation** of the saleable capacity.

PRODUCTION OFFICE

We have a production office with private access in our back of house with wired internet connection, fridge and coffee facilities.

SPECIAL EFFECTS

Smoke & haze may be used freely. Pyrotechnics & lasers may only be used by prior arrangement a minimum of **4 working weeks** prior to the performance date(s).

We will require both method statement, proof of insurance and risk assessments for our records, all operators must be deemed competent. Where appropriate we will have to consult Torbay council for clearance.

MERCHANDISE

Please note we do not charge a merch fee at Arena Torquay. We will provide tables, we can also arrange sellers if requested in advance for a fee.

RIDER

Rider will be provided by us within reason. Please let us know all of your rider requirements in writing to be agreed prior to signing our contract of engagement.

VENUE INFORMATION

DE-RIG CHARGES

Please note that when our house PA or lighting is required to be removed to facilitate touring production we will levy a de-rig charge at cost price to your show to cover removal & reinstatement works.

PRODUCTION PARKING

There is plenty of paid parking available at both the front and rear of the venue which becomes free parking after 6pm.

The Load in doors are on the road at the rear of the venue which is large enough for tour buses and production vehicles, there is a large loading bay that we can reserve if given prior notice of your arrival times but if this unavailable for whatever reason we will pay for any parking costs accrued during the load in process only.

After load in is complete coach and lorry parking is available less than 5 minutes drive away from the venue at **Sheddon Hill Car Park**, for cars there are over 850 parking spaces within 5 minutes of the venue.

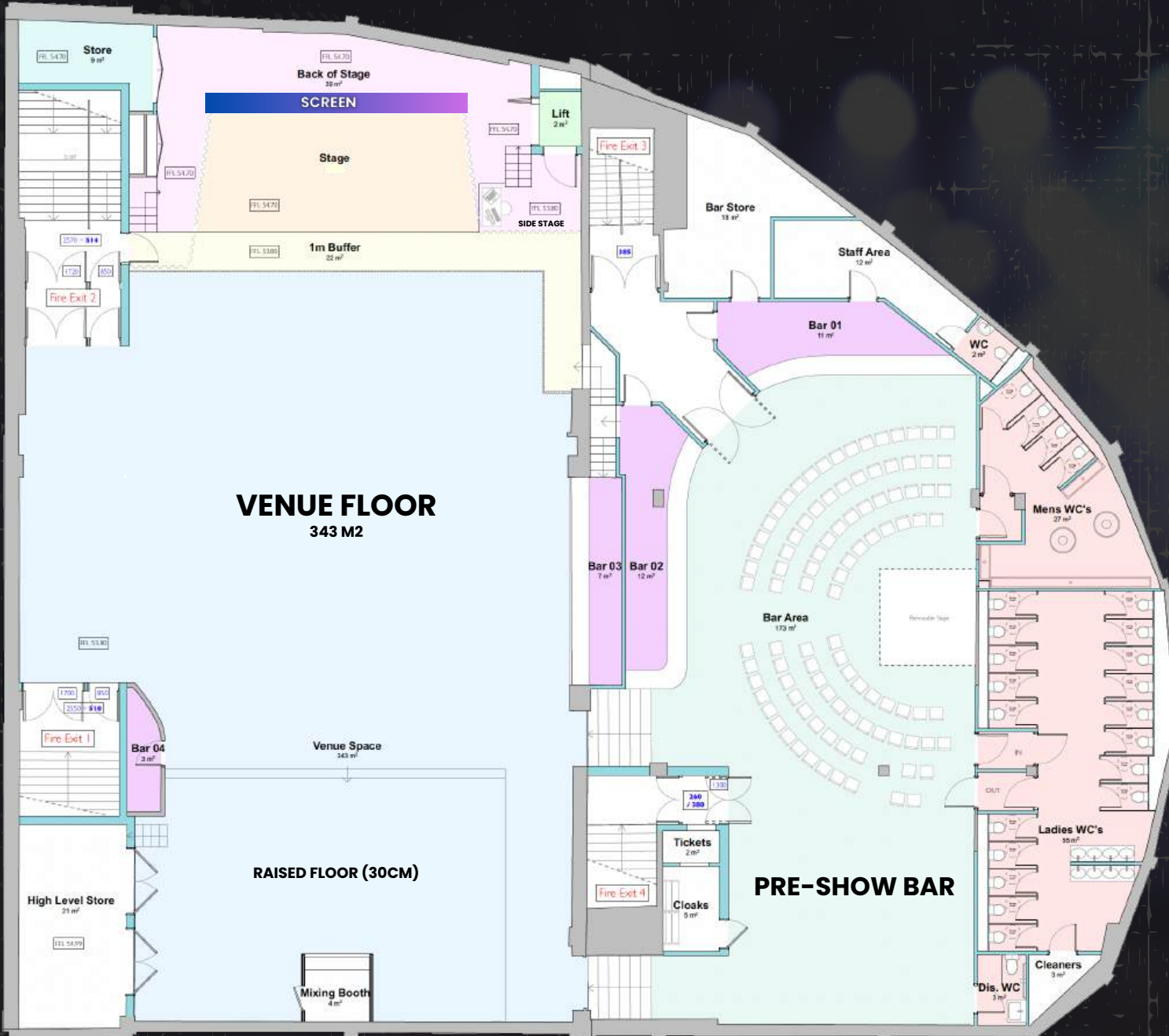

DIMENSIONS:

VENUE FLOOR: 343m²

STAGE: 38m²

PRE-SHOW BAR: 200m²

SOUND BOOTH: 4m²

DRESSING ROOMS X3: 13m²
(Downstairs - accessed from stage right)

GREEN ROOM: 21m² (approx)
(Downstairs - accessed from stage right)

PRODUCTION OFFICE:
5m² approx (Downstairs - accessed from stage right)

LOAD IN LIFT: 2m² 500kg max

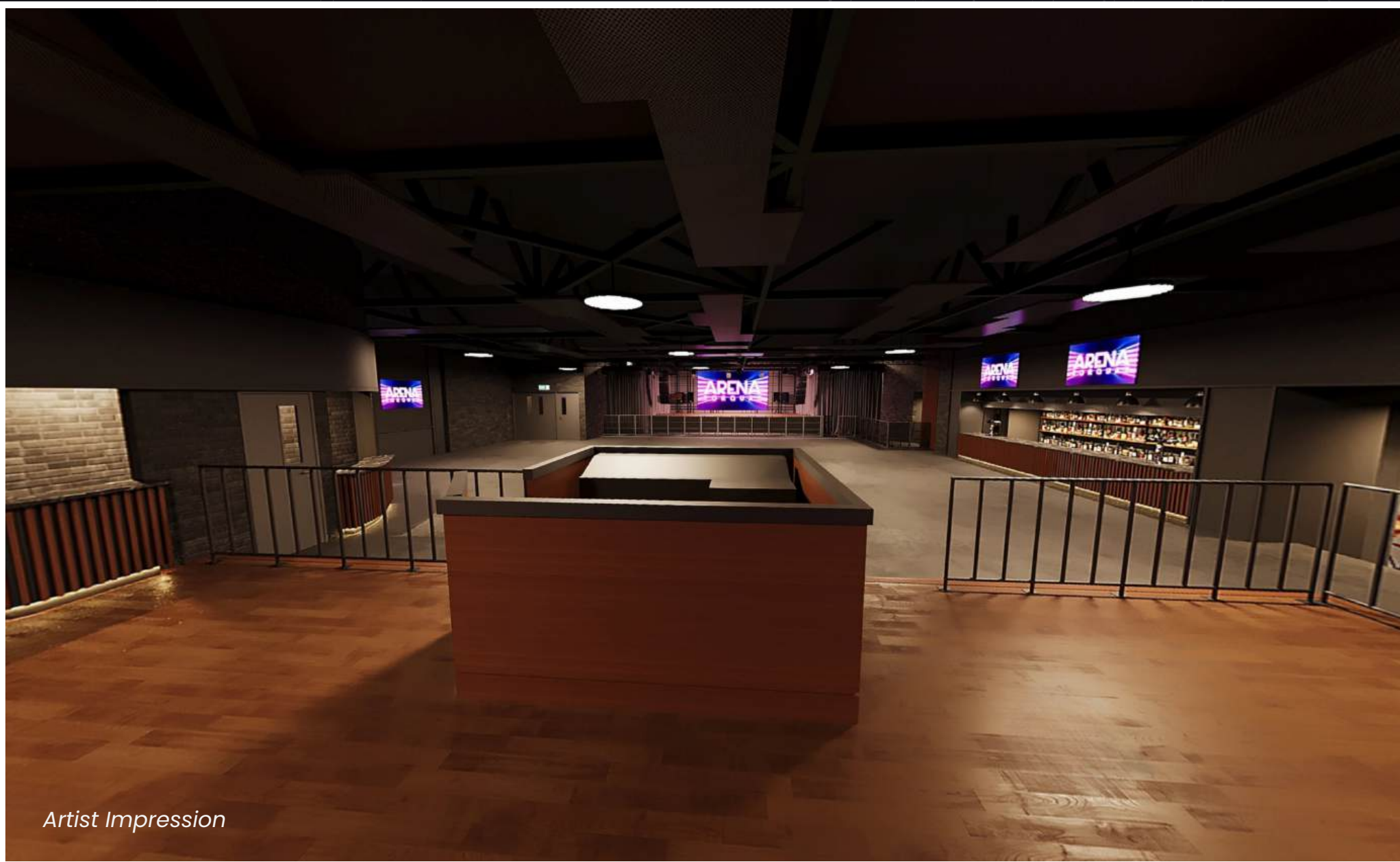

Artist Impression

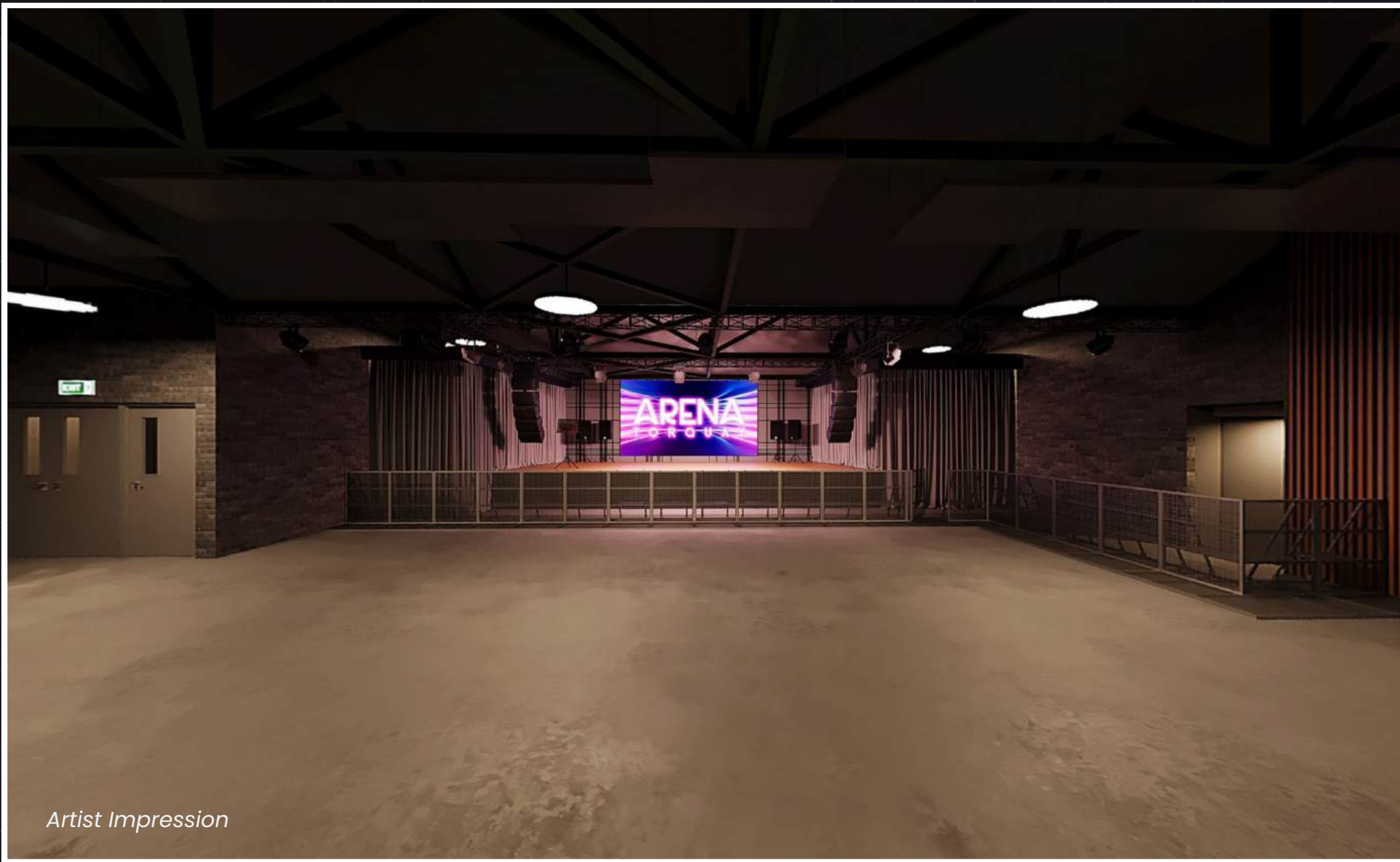

Artist Impression

Artist Impression

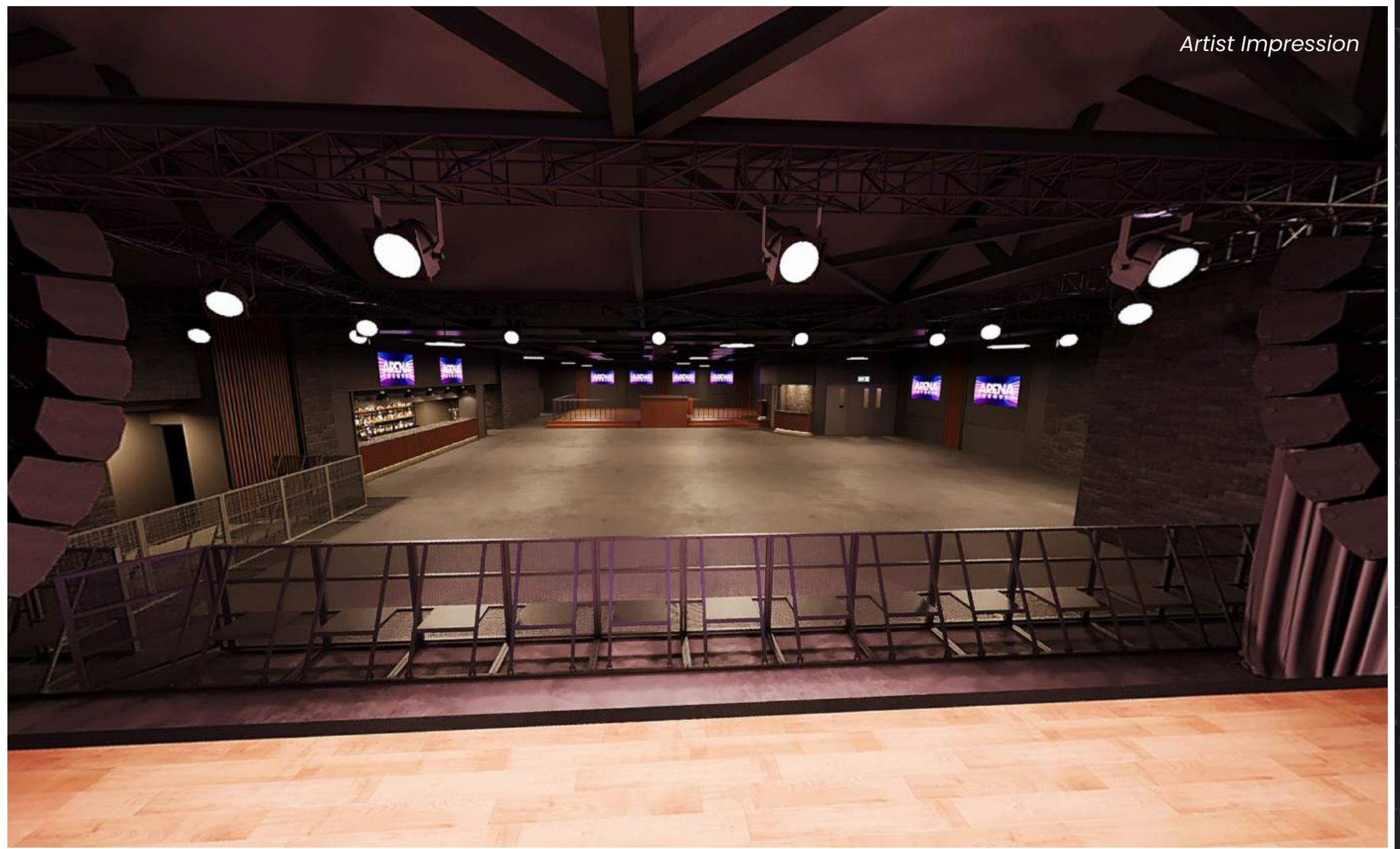

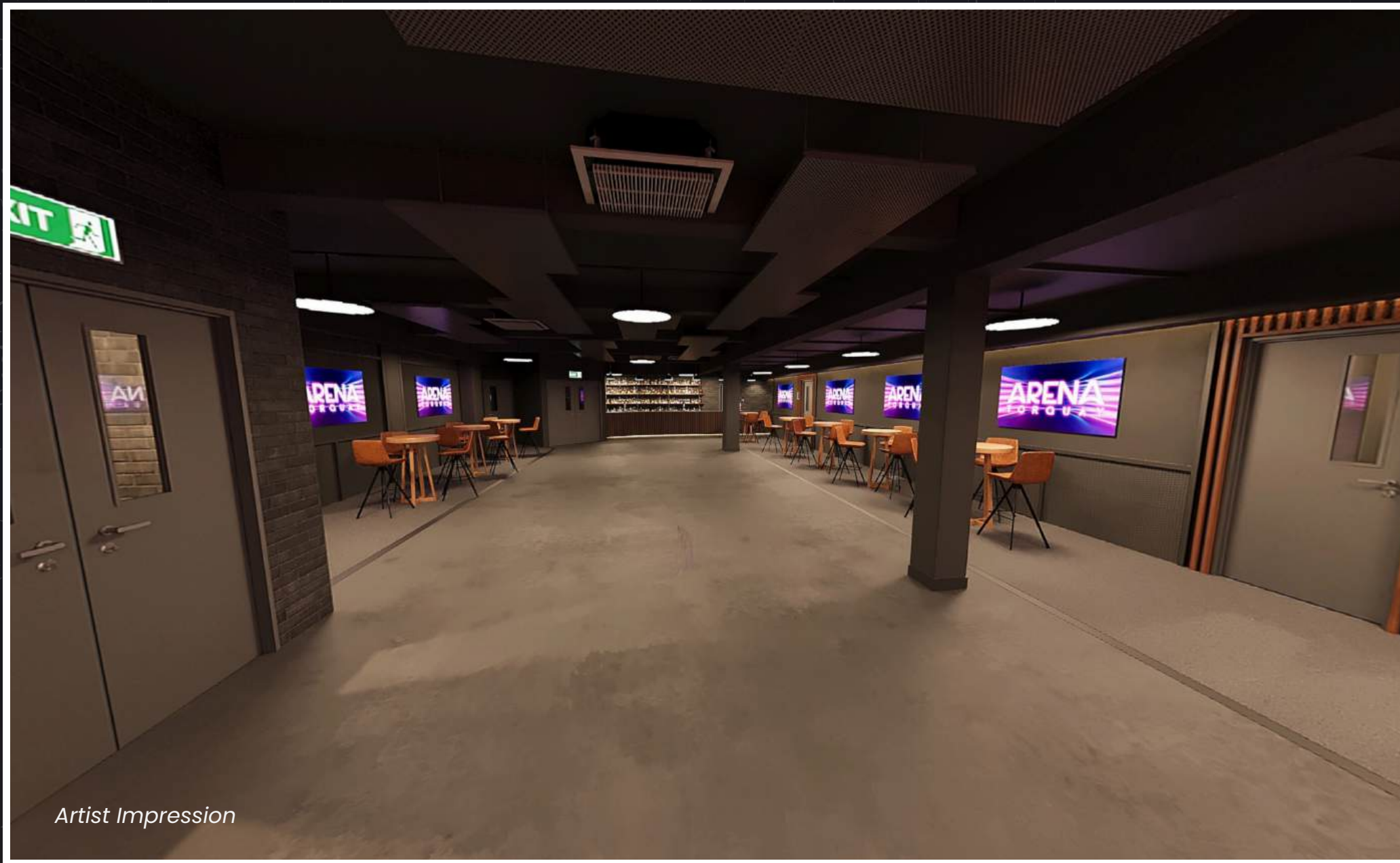

Artist Impression



Artist Impression

SOUND

Our Line Array System is currently being finalised, a tech spec for this will be sent out to all clients as soon as possible.

DESK

Allen & Heath
dLive/Avantis

Or

Yamaha QL5

LIGHTING

- **Desk:** FOH Avo Tiger Touch
- **Multicore:** 3w Dmx 5xlr 2w Cat 5e RJ45
- **FOH:** 6 x S4 Junior 2 x Chauvet Q Wash 560Z
- **Mid Truss:** 4 x Martin Mac 350 Entour 4 x Chauvet Q Wash 560Z 6 x Thomas Pixel Par 90 2 x Anytronics
- **Back Truss:** 6 x Robe Robin 300e 6 x Chauvet Colorado Zoom 2 x Chauvet Led Strobe 1 x Anytronics
- **Smoke:** 1 x Chavet Arena

SCREEN

- 6x3m LED screen wall across back of stage

MONITORING

- Soundcraft Vi 1 64 in / 24 out
- Comms from FOH to MONS
- 7 x Wedge mixes 600W MP4 1 x Drum Sub AA215 1 x Listen 600W MP3 2 x Side Fills FD2 & Sub

Please Note: All tech quoted is subject to change, additions & upgrades.

Equipment load in for Arena Torquay is located on a large but quiet road at the rear of the venue using two different access options:

LOADING IN



LIFT LOAD IN:

The rear of the venue has double door access opposite the church directly into a goods elevator with a floor space of 2m x 2m and a maximum load of 500kg which crew can use to transport bulkier gear directly to back stage and stage left level. We recommend having a member of crew at the top whilst someone loads the lift below so nobody has to ride with the equipment for maximum efficiency.

Coaches and splitter vans can either use the loading bay on the road outside the venue or the parking bays along the street, with enough prior notice we can make sure space is reserved for you but if for any reason there is no space available vehicles can park up tightly next to our rear access doors and load in from there.

We will pay for any parking costs or charges accrued during the load in process only, parking is then free from 6pm.

FIRE EXIT LOAD IN:

5m across from the lift load in doors is a large double fire exit with a 4.5m staircase which comes out on stage right at pit barrier level - equipment can then be lifted on to the stage or taken up the stage right steps.

LOADING OUT

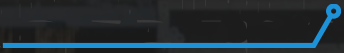

Load out can be achieved through either method used for loading in.

HIRE

[Email for details](#)

*All additional fees, levies and commissions are detailed in our contracts of engagement.

INCLUDES:

- Sound Engineer & Lighting Engineer (**6 hrs included**)
- Use of in-house tech, LED screens
- Box office staff
- Green Room & Dressing Rooms access

EXCLUDES:

- Security (**1 x security staff is required per every 100 ticket holders**)

- Contribution to venue marketing services

EXTRAS (if required):

- Crew/Runners
- Towels
- Rider - **Provided by us (agreed in writing)**
- Press/Radio/Billboard
- Merch Seller
- Extra Engineers

TICKET SPLIT

[Email for details](#)

*Percentage to be agreed prior to contract. All additional fees, levies and commissions are detailed in our contracts of engagement.

INCLUDES:

- Sound Engineer & Lighting Engineer (**6 hrs included**)
- Use of in-house tech, LED screens
- Box office staff
- Green Room & Dressing Rooms access

EXCLUDES:

- Security (**1 x security staff is required per every 100 ticket holders**)

- Contribution to venue marketing services

EXTRAS (if required):

- Crew/Runners
- Towels
- Rider - **Provided by us (agreed in writing)**
- Press/Radio/Billboard
- Merch Seller -
- Extra Engineers

GUARENTEED FEE

At Arena torquay we are open to any and all fee options. If you would like to perform or hold an event with us but do not want to deal with the pressure or hassle of all the marketing & ticket sales administration then we are happy to take all of that away from you by negotiating with you a one time fee that you are happy with and in turn the venue will retain **100%** of the ticket revenue.

At Arena Torquay the comfort and privacy of our visiting artists and their production teams are very important to us. Our Private facilities consist of **Dressing room 1** for our headliners & **Dressing Rooms 2 & 3** for support acts or crew all with en suite toilet & shower facilities. We also have a large communal green room for relaxing in and access to an artist & crew kitchen.

DRESSING ROOMS

All three private dressing rooms in the venue have the below features:



Large Fridge



Large TV & Games Console/Firestick etc



Sofa & Seating areas



Private shower & bathroom access



Wardrobes

TOILETS & SHOWERS

All dressing room bathroom facilities in the venue have the following:



1 x Toilet



1 x Shower



1 x Sinks



Fresh Towels (if ordered)



Soap & Handwash

THE GREEN ROOM

We have a large communal green room next to the dressing rooms with the following:



Large Table & Chairs



Large TV & Firestick



Sofa & Seating areas



Tea & Coffee Facilities



Games

DIRECTIONS FROM TORQUAY HARBOUR

- When exiting the dual carriageway for Torquay continue until you start seeing signage for “sea front” or “harbour” and follow them.
- Once you have passed The princess theatre on your right take the first left at the roundabout and follow the road until you see the clock tower.
- Take the first left at the clocktower and continue up the hill to the traffic lights, Arena Torquay will be in front of you on the right-hand side

DIRECTIONS FROM BABBACOMBE

- If you came via the coast road then continue through Babbacombe following the signs for the “sea front” or “harbour”
- Once you see the bowling alley on your left-hand side you will see that Arena Torquay is just two buildings down from there.

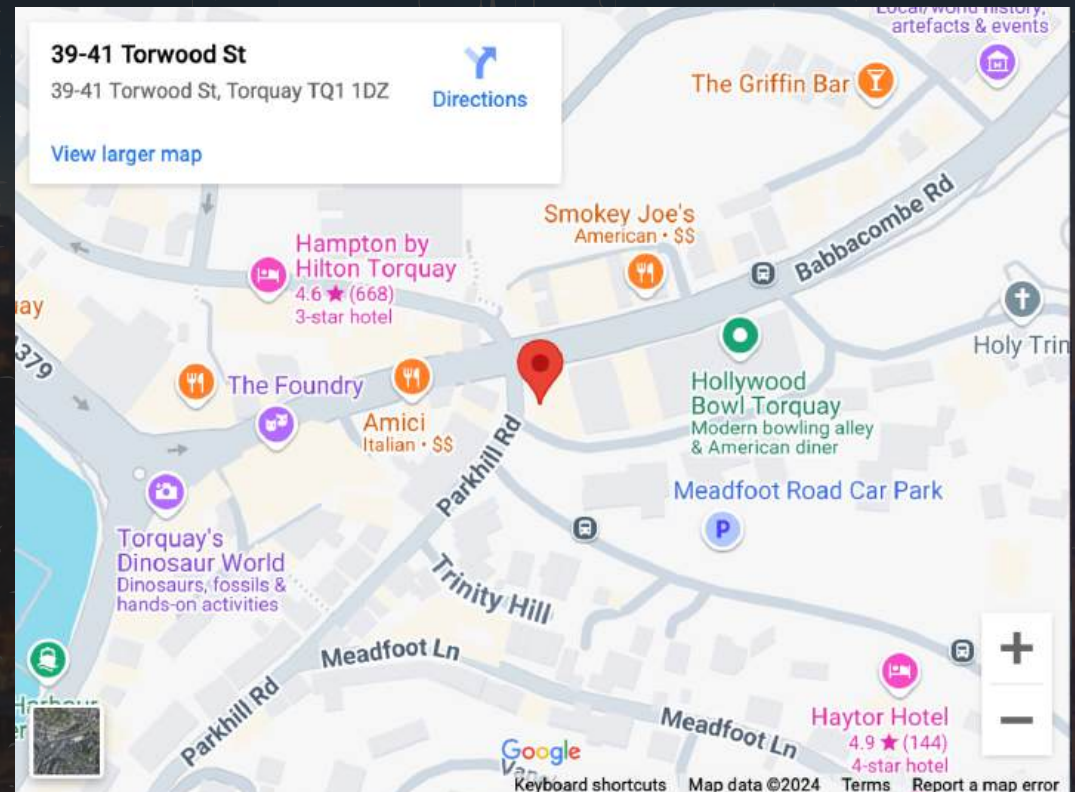

ADDRESS:

ARENA TORQUAY, 39-41 TORWOOD STREET,
TORQUAY, DEVON, TQ1 1DZ



HOSPITAL

Torquay Hospital
Newton Road, Torquay
TQ2 7AA

Distance from venue:
3 miles



AIRPORTS

Exeter Airport
Exeter, Devon EX5 2BD

Bristol Airport
Bristol Airport, Lulsgate
Bottom, Bristol BS48 3DY

Distance from venue:
Exeter - 26.9 miles
Bristol - 87 miles



HOTELS

Hampton by Hilton
The Terrace, Torquay
TQ1 1DP

Premier Inn
Montpellier Road,
Torquay TQ1 1DL

Distance from venue:
Both 440 feet



TAXIS

Torbay Cab Company
01803 292292

Torbay Taxis Ltd
01803 211611

1st Class Cars
01803 211611

Nearest Taxi Rank:
213 feet

RESTAURANTS

Thai: Jun Jaow Thai Restaraunt
Distance From Venue: Next Door

Indian: East in the West
Distance From Venue: Next Door

Italian: Amici's Italian Restaurant
Distance From Venue: (213 feet away)

Chinese: Tang Tang Chinese Restaurant
Distance From Venue: Opposite us (30 feet)

Steak: Smokey Joe's Steak house
Distance From Venue: Opposite us (30 feet)

Advance Bookings:
If you require table bookings or takeaways during your performance date we can make these arrangements if you contact us before your arrival.

ARENA

T O R Q U A Y



info@arenatorquay.com



www.arenatorquay.com



[@arenatorquay](#)